

Ergonomic design, maximum quality and security. Precision and strength defines the new Parrilla by MIBRASA®. Thanks to the carefully engineered design with elevation system and positional brake, the Mibrasa® Parrilla effortlessly regulates the height of the grill from the heat of embers with maximum safety and minimum maintenance. The Mibrasa® Parrilla lets us sear, cook and rest our ingredients, achieving the optimal result every time.

The base is lined with refractory bricks to ensure maximum heat efficiency and resistance to pure fire. And the built-in cooling system in outer case guarantees a maximum level of security.

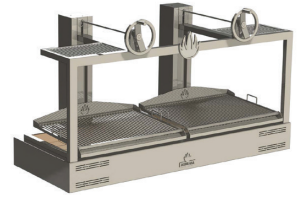

ACCESSORIES INCLUDED

- 2 round bar grills
- 2 heating rack grills
- Ash shovel
- Ember poker
- Mibrasa tongs
- Grill brush
- Mibrasa Ecofire firelighters

OPTIONAL ACCESSORIES

- V-shape grill
- Extra round bar grill
- Parrilla stand
- Stand casters

SAFETY STANDARDS AND INSTALLATION GUIDELINES

- Combustible floor protection dimensions:
 - a. 762 mm to each side of the Parrilla
 - b. 914 mm in front of the Parrilla
- Clearances to combustible construction/other appliances:
 - a. Unit to backwall = 460 mm
 - b. Unit to sidewalls = 720 mm
- The workspace for the chef should be 700 mm from the front of the Parrilla.
- A lifting device should be used whenever possible to lift the Parrilla and place on the countertop/stand.

GRILL OPTIONS:

Round bar grill
(Included as standard unless stated otherwise at time of order)

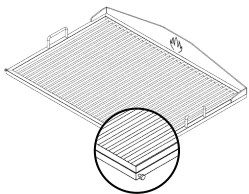

V-shape grill

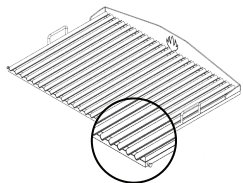

FRONT VIEW

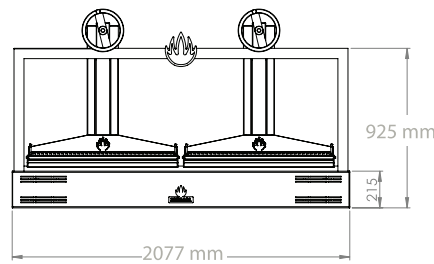

SIDE VIEW

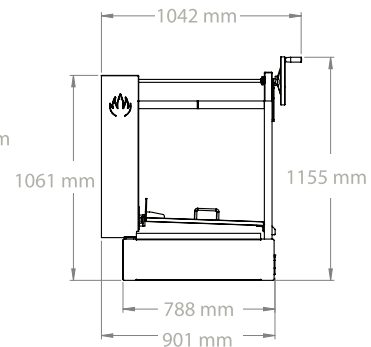

TOP VIEW

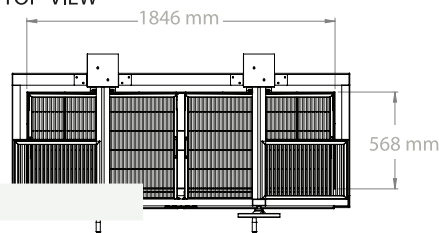

GRILL DIMENSIONS

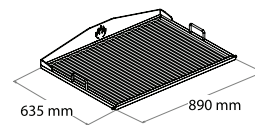

HEATING RACK DIMENSIONS

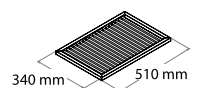

TECHNICAL INFORMATION

Fire up time* (min)	30
Cooking temperature (°C)	250
Initial charcoal load* (kg)	30
Charcoal load duration* (hours)	7
Equivalent power* (kW)	6
Exhaust rate (m3/h)	4000
Installation height* (mm)	700
Net weight* (kg)	620

SHIPMENT INFORMATION

Gross weight (kg)	770
Dimensions (WxDxH mm):	1100x2200x1200 mm

SPECIFICATIONS ARE SUBJECT TO CHANGE WITHOUT NOTICE.

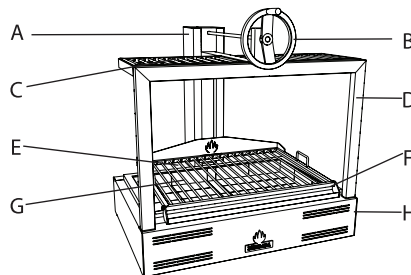

A	Reverse elevating system
B	Elevating wheel
C	Heating rack
D	structure
E	Grill
F	grease collector
G	Refractory bricks
H	Main body